

IMPLANT ONE IMPRESSION POST, CLOSED TRAY *(Impression Pin, Impression Coping)*

Used to make closed tray impressions.

- Made from 6AL4V E.L.I. Titanium.
- Exclusive plastic cap prevents infiltration of impression material into screw access hole.

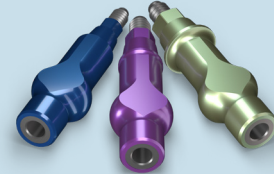

- Plastic cap prevents impression material from entering access hole.
- Cap remains in impression when removed and facilitates a firm seat when coping is re-seated in the cured impression.
- Flat face is parallel with hex flat.

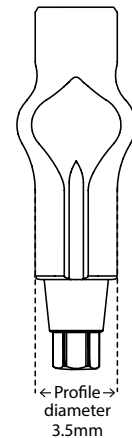

Specifications
Material: 6AL4V E.L.I. Titanium Profile Diameter: 3.5 mm

NOTE: WHEN FULLY SEATED, IMPRESSION POST SITS FLUSH WITH THE TOP OF THE IMPLANT.

Part Numbers

300 series	400 series	500 series
IPC-0300-00	IPC-0400-00	IPC-0500-00

REPLACEMENT CAPS
PACK OF 10 - IPP-0000-10

